

QASB-B

SMA to BNC

Features:
* Low VSWR

Applications:
* Wireless
* Transmitter
* Laboratory Test
* Radar

Electrical

Frequency: DC~6GHz
DC~3GHz (bulk head)
VSWR: 1.35 max.
1.25 max. (bulk head)
Impedance: 50Ω

Mechanical

RF Connectors: SMA
BNC
Outer Conductor: Nickel plated brass
Dielectric: PTFE
Inner Conductor: Gold plated brass or gold plated phosphor copper

Environmental

Operating Temperature: -55~+155°C

How To Order

QASB-MM-B - SMA(m) to BNC(m), Outline A

QASB-FM-B - SMA(f) to BNC(m), Outline B

QASB-MF-B - SMA(m) to BNC(f), Outline C

QASB-FF-B - SMA(f) to BNC(f), Outline D

QASBH-FF-B - SMA(f) to BNC(f), bulk head, Outline E

Customization is available upon request.

Outline Drawings

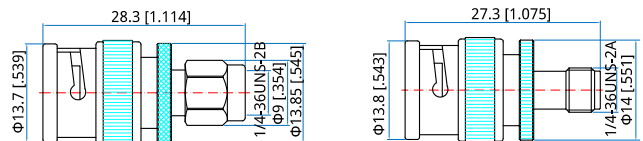

Outline A

Outline B

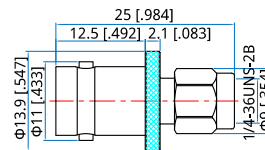

Outline C

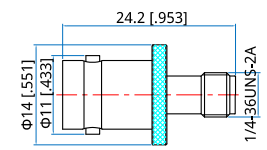

Outline D

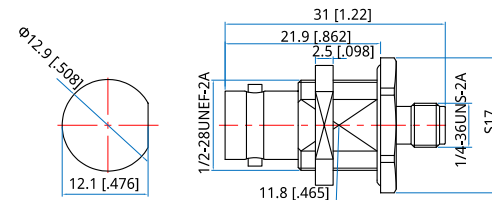

Outline E

Unit: mm [in]

Tolerance: $\pm 0.2\text{mm}$ [$\pm 0.008\text{in}$]